



D Montage- und Bedienungsblatt

Beachten Sie bitte den Text in der Betriebsanleitung!

GB Assembly and operating instruction sheet

Please follow the text in the operating instruction manual!

F Fiche de montage et d'utilisation

Veuillez tenir compte du texte de la notice d'instructions!

BG Ръководство за монтаж и обслужване

Моля обърнете внимание на текста в ръководството за обслужване!

CZ Návod k montáži a k použití stroje

Dbejte všech pokynů v návodu!

H Szerelési- és kezelési útmutató

Kérjük, tartsa be a kezelési útmutató utasításait!

HR Upute za montažu i uporabu

Molimo Vas da obratite pozornost na tekst u uputama za rukovanje!

I Istruzioni per l'uso e per il montaggio

Prestare attenzione a quanto riportato nelle istruzioni per l'uso!

NL Montage- en bedieningsblad

Houdt u alstublieft rekening met de tekst in de gebruiksaanwijzing!

PL Instrukcja montażu i obsługi

Zwracać uwagę na tekst instrukcji obsługi!

RO Foaie cu instrucțiuni de montare și utilizare

Vă rugăm să respectați textul din instrucțiunile de utilizare!

SK Návod na montáž a na použitie stroja

Dodržiavajte všetku pokyny v návode!

SLO Navodila za montažo in upravljanje

Upoštevajte besedilo v navodilih za uporabo!

TR Montaj ve işletme kılavuzu

Lütfen işletme kılavuzundaki metne dikkat edin!

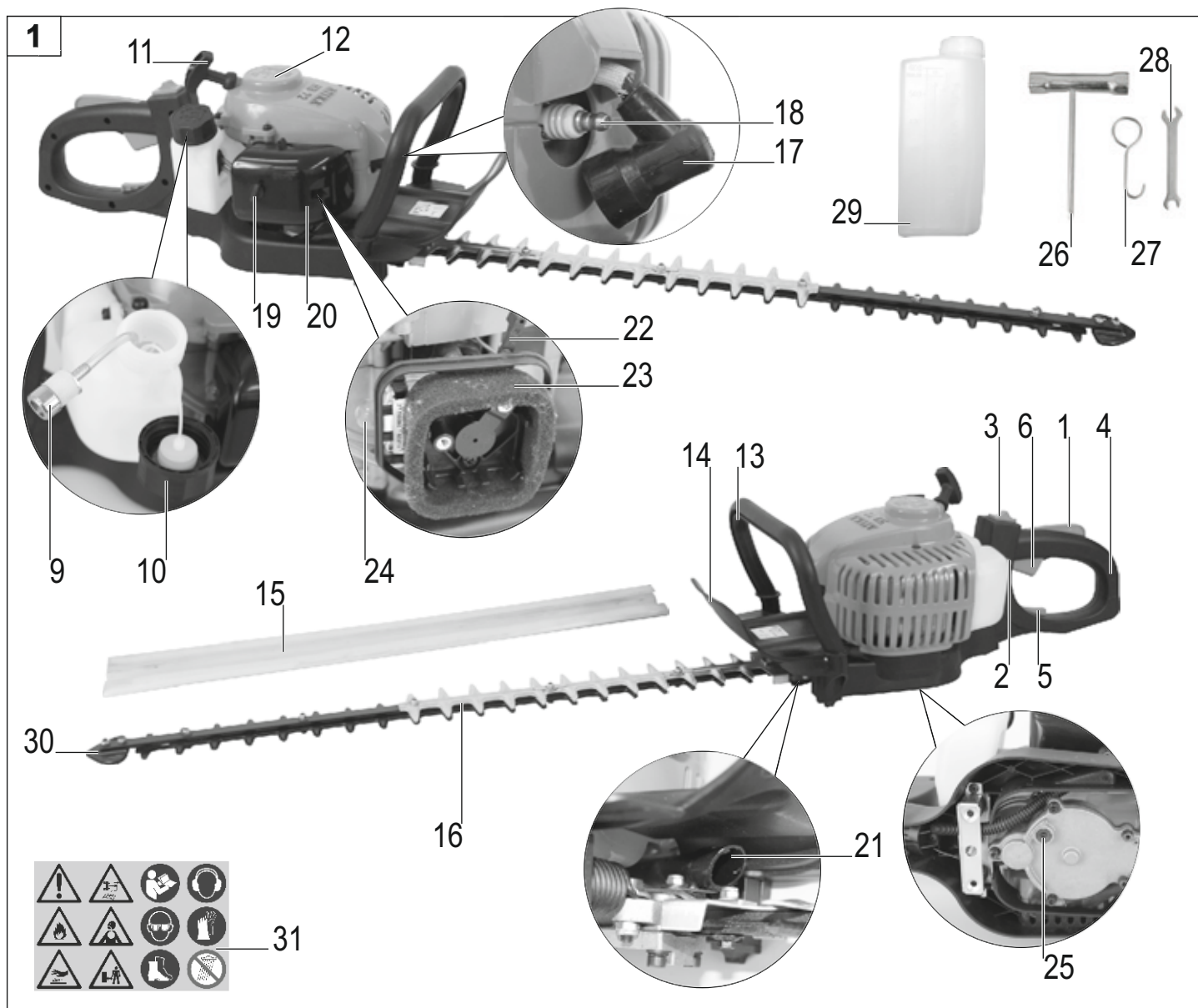

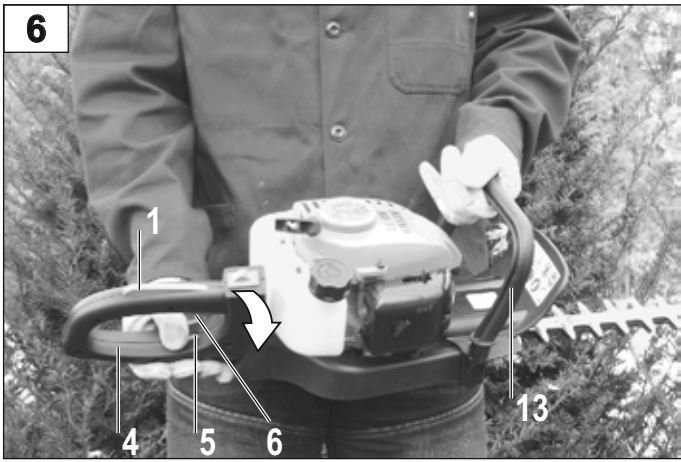
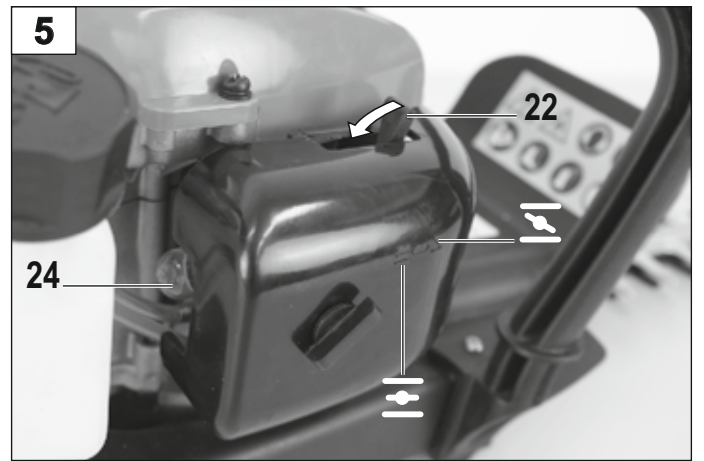
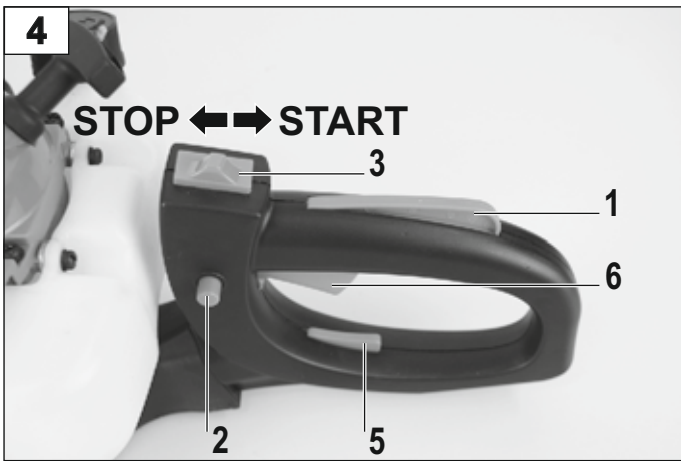
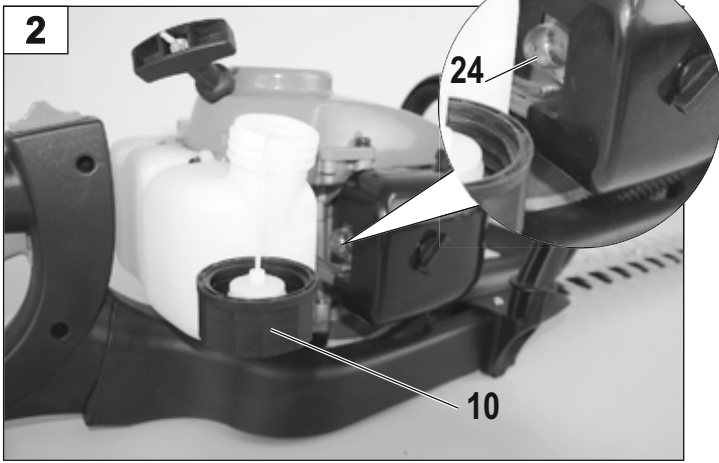

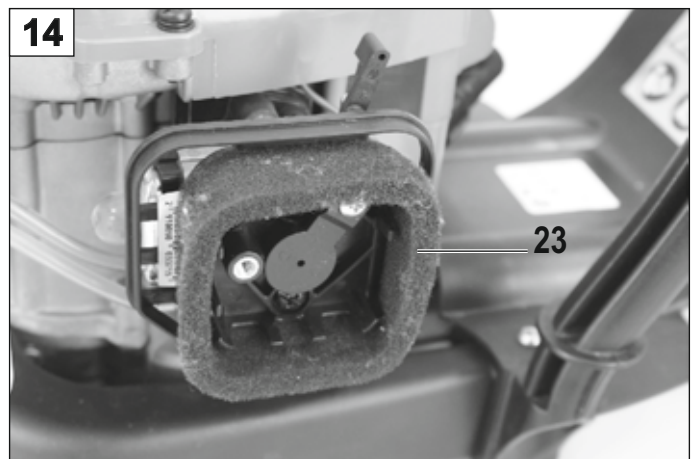
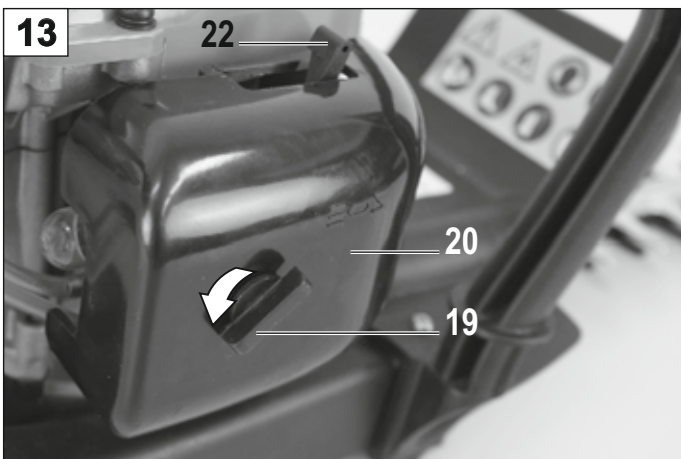
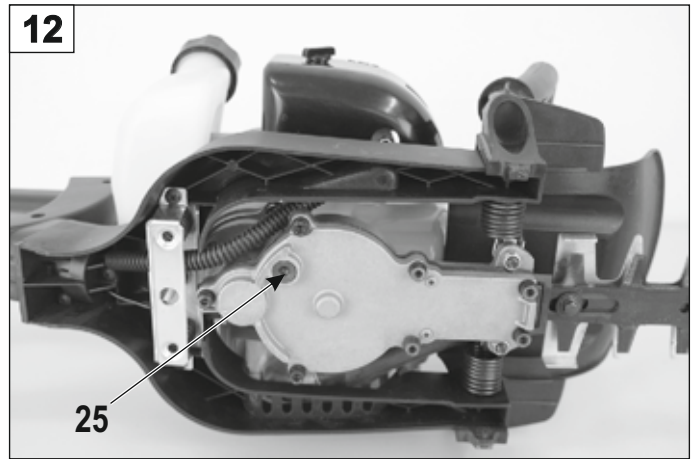
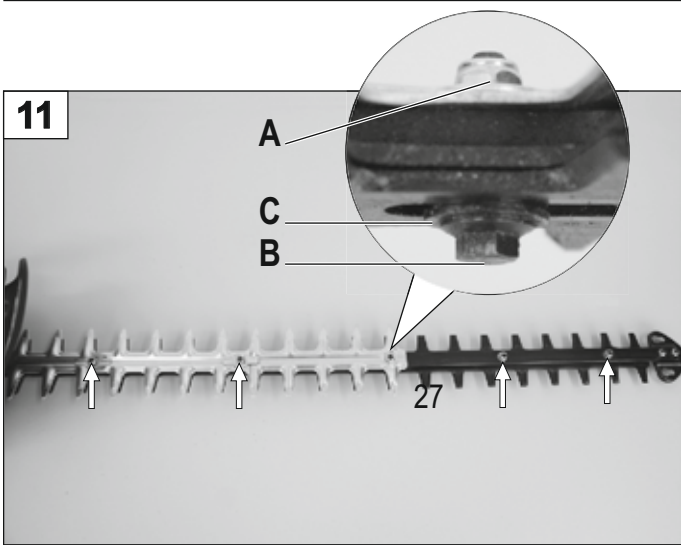
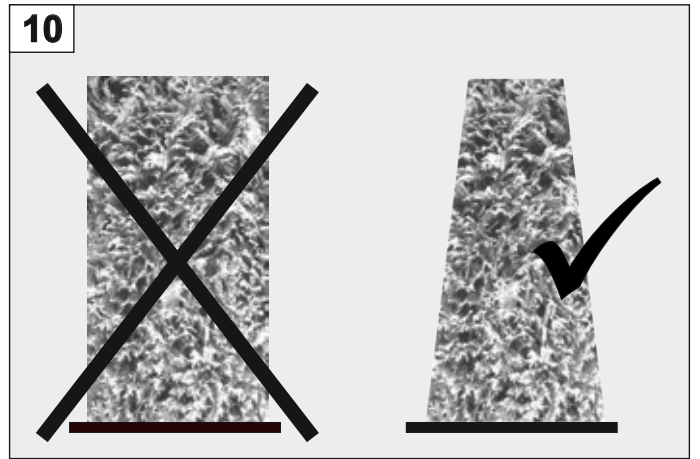
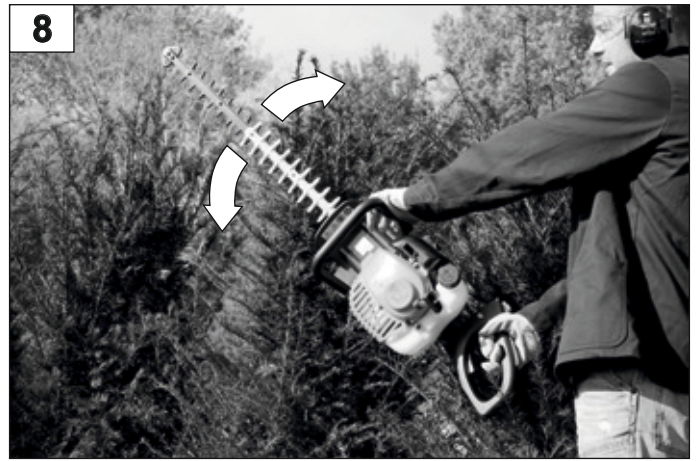
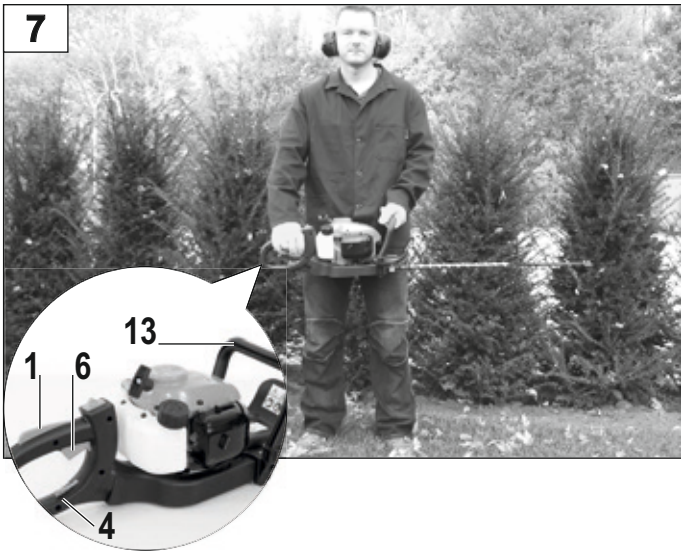

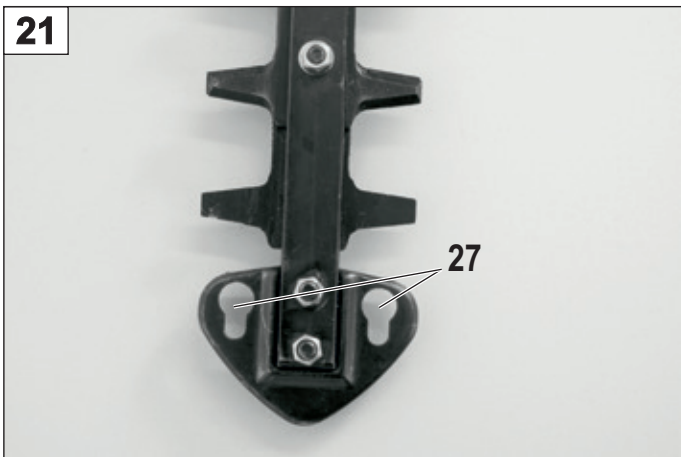
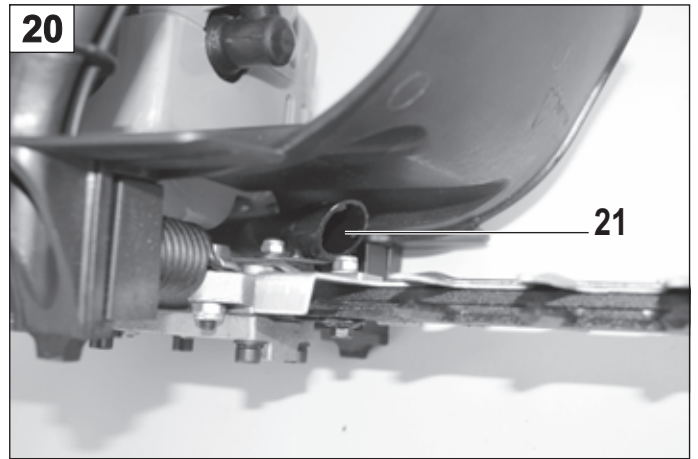
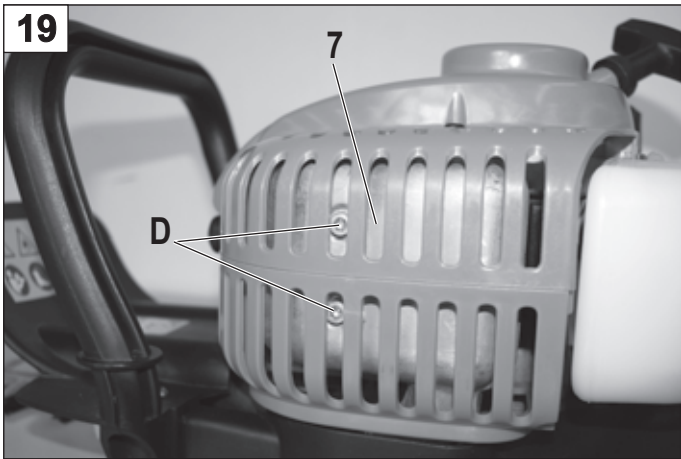
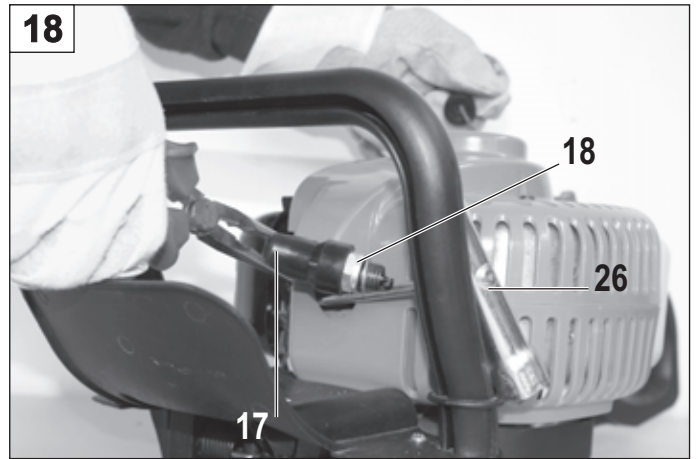
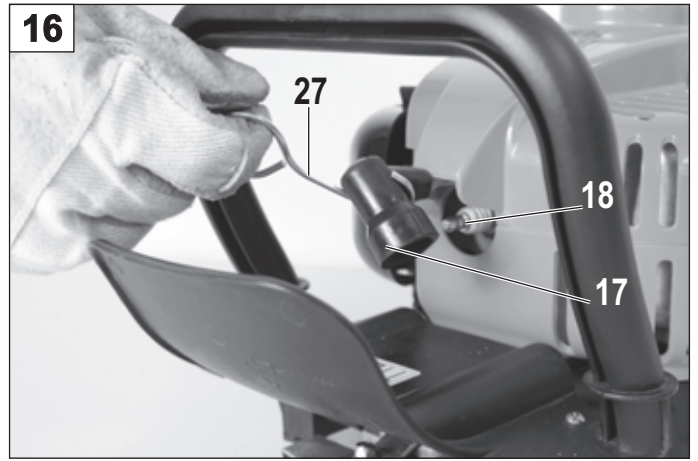
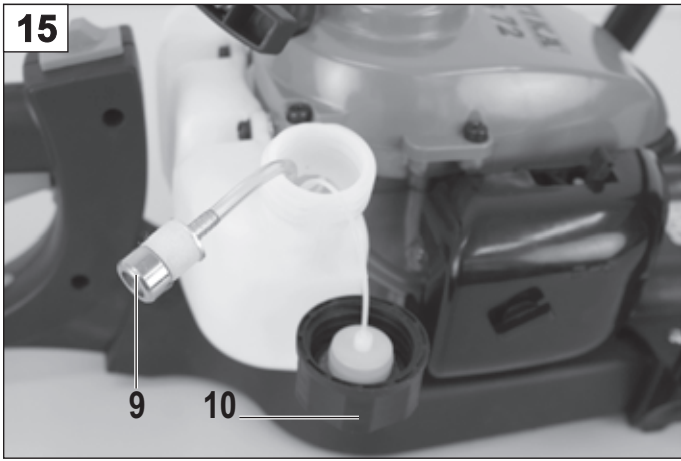

ATIKA GmbH
 Schinkelstraße 97, 59227 Ahlen
 Postfach 21 64, 59209 Ahlen
 Germany
 Tel.: +49 (0) 23 82 / 8 92-0
 Fax: +49 (0) 23 82 / 8 18 12
 E-mail: info@atika.de
 Internet: www.atika.de